



**BILL OF MATERIAL**

ITEM	QTY	PART NO.	DESCRIPTION	DWG. NO.
1	6	VY5369	SIDE ARM CLAMP	C800291
2	3	VY4951	UPPER MOUNTING PIPE	B93272
3	3	VY4952	LOWER MOUNTING PIPE	B93273
4	3	VY4953	VERTICAL BRACE	B93274
5	6	VY4954	UTAO BRACE	B93275
6	2	VY2659	WALKWAY PANEL	B93276
7	1	VY2659	WALKWAY PANEL	B93276
8	3	VY4237	WALKWAY SUPPORT ANGLE	B93277
9	6	WY23	WALKWAY SUPPORT ANGLE	B93277
10	6	WY23	WALKWAY SUPPORT ANGLE	B93277
11	12	J107A	U-BOLT CLAMP	SX230258
12	0	AA44AP	U-BOLT ASST. W/ NUTS & WASHERS	B9242A
13	4	Z100750A	1/2" X 1-1/4" BOLT ASST.	C72042A
14	21	Z100760A	1/2" X 1-1/2" BOLT ASST.	C72042A
15	12	Z100770A	1/2" X 1-1/2" BOLT ASST.	C72042A
16	12	Z100780A	1/2" X 1-1/2" BOLT ASST.	C72042A
17	12	J1083A	U-BOLT ASST.	B93103B
18	12	J1083A	U-BOLT ASST.	B93103B
19	12	J1083A	U-BOLT ASST.	B93103B

GENERAL NOTES

1. WASHERS ARE PROVIDED WITH ALL SLOTTED HOLES.
2. ITEM NUMBER 8 MAY BE ARRANGED IN SUCH A MANNER AS TO BE REMOVED FROM ONE END TO THE OTHER BY SLIDING WALKWAYS FROM ONE END TO THE OTHER.
3. CHECK AND, IF REQUIRED, RETIGHTEN ALL BOLTS AFTER ANTENNA INSTALLATION AND AT EACH SCHEDULED INSPECTION THEREAFTER.

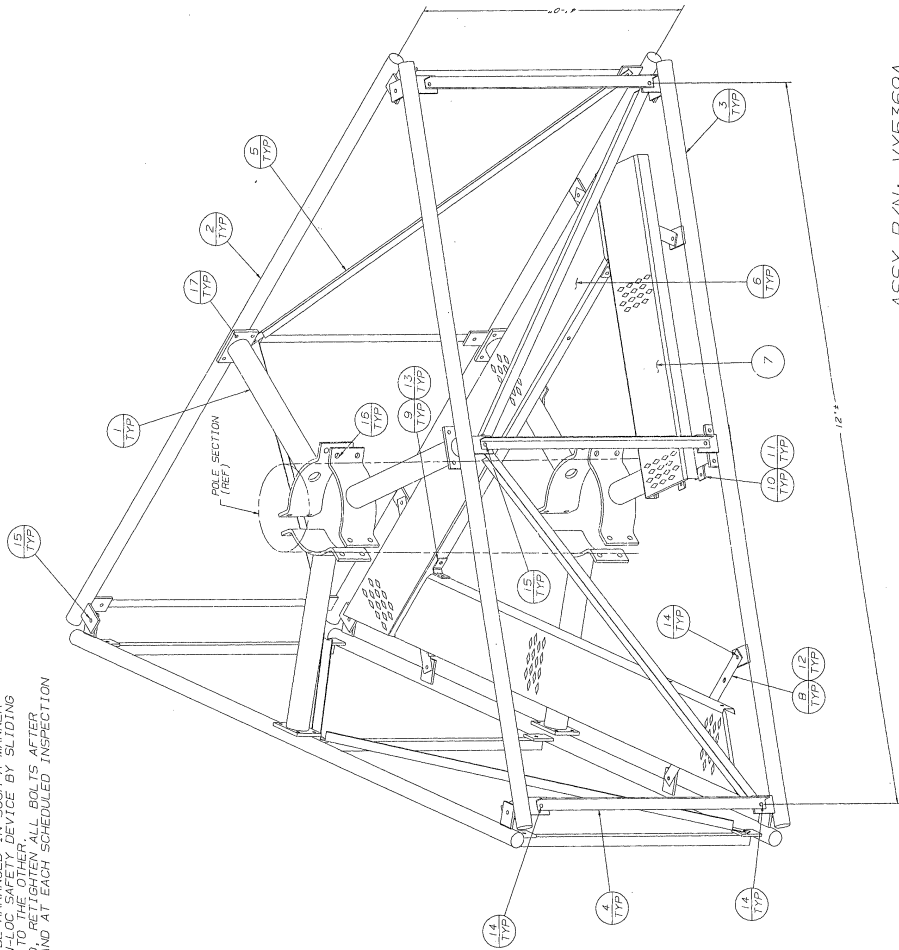

ASSY P/N: VY5369A

THE FOLLOWING INFORMATION IS FOR THE USER'S INFORMATION ONLY. IT IS THE USER'S RESPONSIBILITY TO VERIFY THE INFORMATION IS CORRECT FOR THE PROJECT AND TO OBTAIN NECESSARY PERMITS FROM THE LOCAL, STATE AND FEDERAL AUTHORITIES.

**ROHN**  
 POLE MOUNTING FRAME  
 WITH WALKWAY  
 FOR 36" POLE

DATE: 12-22-08  
 DRAWN: JON 2-22-08  
 CHECKED: JON 2-27-08  
 APPR. BY: JON 2-27-08  
 REV. 001: 12-22-08  
 DWG. FILE: 0960658