

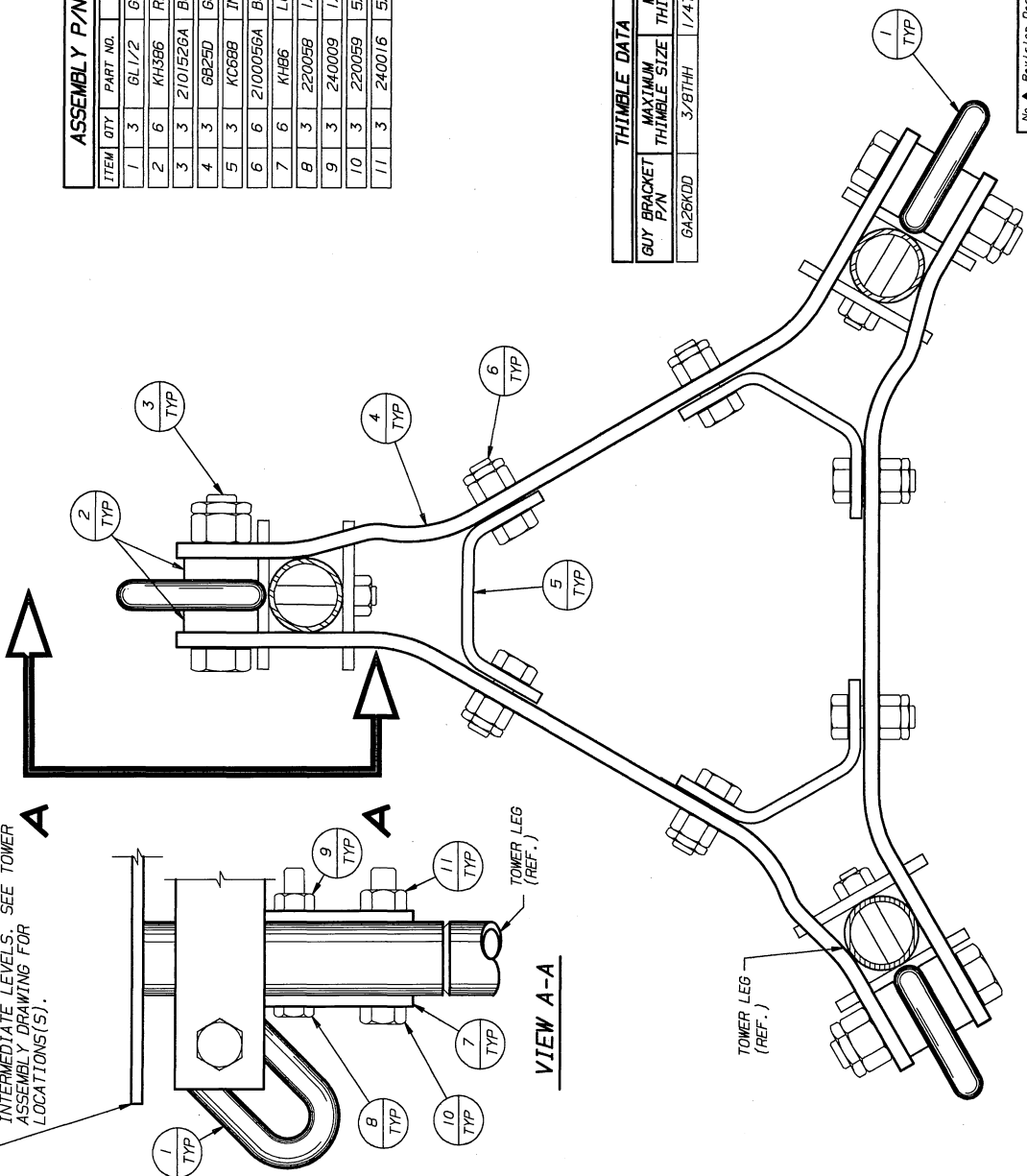

APL256 TOP PLATE (REFERENCE).  
 GUY BRACKET MOUNTED AT SECTION  
 JOINTS. CAN BE ASSEMBLED AT  
 TOP OF TOWER AS SHOWN AND/OR  
 INTERMEDIATE LEVELS. SEE TOWER  
 ASSEMBLY DRAWING FOR  
 LOCATIONS(S).



**ASSEMBLY P/N 6A26KDD BILL OF MATERIAL**

ITEM	QTY	PART NO.	DESCRIPTION	DWG NO.
1	3	6L1/2	GUY LINK	N/A
2	6	K1386	RINGFILL (3/8" THICK)	B770314
3	3	2101526A	BOLT ASSY 1/2 x 3	C770404
4	3	6B250	GUY BRACKET	B870896
5	3	KC688	INNER BRACKET	B870897
6	6	2100056A	BOLT ASSY 3/8 x 1-1/4	C770404
7	6	K1486	LOAD PLATE	C760516
8	3	22005B	1/4 X 2 BOLT	
9	3	240009	1/4 NUT	
10	3	220059	5/16 X 2 BOLT	
11	3	240016	5/16 NUT	

**THIMBLE DATA**

GUY BRACKET P/N	MAXIMUM THIMBLE SIZE	MINIMUM THIMBLE SIZE
6A26KDD	3/8THH	1/4TH-5/16THH

**MAXIMUM VERTICAL DOWNPULL**

26KD	- 1.90 KIPS
------	-------------

PLAN VIEW

VIEW A-A

No. **1** Revision Description  
 THIS DRAWING IS THE PROPERTY OF ROHN. IT IS NOT TO BE REPRODUCED OR TRANSMITTED IN ANY FORM OR BY ANY MEANS, WITHOUT OUR WRITTEN CONSENT.

Date **4/10/89** Rev. By **AK** Ckd. By **AK** Mpd. By **AK**

**R O H N**

Title: **GUY BRACKET ASSEMBLY FOR 26KD TOWER**

Scale	NAME	By	Date
	JHD	JHD	4/6/89
	WZM	WZM	4/7/89

Checked: **WZM** 4/10/89  
 App. Eng.: **AK** 4/10/89  
 App. Sales: **AK** 4-10-89

DRAWING NO.: **C890812**